

# ANA-QUICK® ACCESSORIES

## LOCK NUTS



### DESCRIPTION:

Polyamide hexagonal metric thread lock nuts for securing connectors in thin or not threaded walls of boxes and cabinets. Made of specially modified polyamide (PA6). Free of halogen, phosphorus, and cadmium. Self-extinguishing and shock-resistant. Temperature range of -40°C to +105°C (+150°C short term).



### DESCRIPTION:

Nickel plated brass hexagonal female thread lock nuts for securing connectors and elbows in thin or not threaded walls of boxes and cabinets. Maximum temperature is +800°C.

## NYLON LOCK NUT

Item ID	Thread Size	Dimensions mm (inches)			Std. Pkg.
		A	B	C	
ATNL-M12B	M12x1.5	18 (0.709)	17 (0.669)	5 (0.197)	100
ATNL-M16B	M16x1.5	24 (0.945)	22 (0.866)	5 (0.197)	100
ATNL-M20B	M20x1.5	28 (1.102)	26 (1.024)	6 (0.236)	100
ATNL-M25B	M25x1.5	35 (1.378)	32 (1.260)	6 (0.236)	100
ATNL-M32B	M32x1.5	47 (1.850)	42 (1.654)	7 (0.276)	100
ATNL-M40B	M40x1.5	57 (2.244)	52 (2.047)	7 (0.276)	50
ATNL-M50B	M50x1.5	68 (2.677)	62 (2.441)	9 (0.354)	50

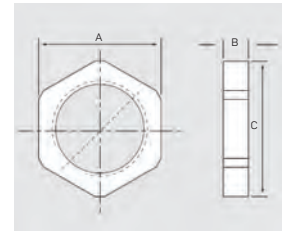

## NICKEL PLATED BRASS LOCK NUT

Item ID	Thread Size	Dimensions mm (inches)			Std. Pkg.
		A	B	C	
ATSL-M12M	M12x1.5	17 (0.669)	15 (0.591)	3 (0.118)	100
ATSL-M16M	M16x1.5	22 (0.866)	20 (0.787)	3 (0.118)	100
ATSL-M20M	M20x2.5	27 (1.063)	24 (0.945)	3.5 (0.138)	100
ATSL-M25M	M25x1.5	33 (1.299)	30 (1.181)	3.5 (0.138)	100
ATSL-M32M	M32x1.5	38 (1.496)	35 (1.378)	4.5 (0.177)	100
ATSL-M40M	M40x1.5	49 (1.929)	45 (1.772)	4.5 (0.177)	50
ATSL-M50M	M50x1.5	60 (2.362)	55 (2.165)	5.5 (0.217)	20

