

METALLIC FITTINGS

SEALTITE® COMPACT FITTINGS STAINLESS STEEL AISI-316 PREMIUM NPT FITTINGS



DESCRIPTION

- New compact design: 20% smaller and 35% lighter than standard SEALTITE® fittings which makes it ideal for tight spaces
- Superior Stainless 316 corrosion resistance, strength and durability
- IP 66/67 rated when installed with approved conduit and tightened to UL-514B/CSA C22.2 18.3 torque specifications
- Approved for both exposed and concealed locations

SPECIFICATIONS

- AISI-316 body with AISI-304 Ferrule and lock nut and PA6 clamping ring
- O-ring and lock nut included
- Colour: silver
- Temp. range: -45° C to + 105° C (-49° F to +221° F)
- cULus Approved # E234207

APPLICATIONS

- Metallic and Type B non-metallic flexible conduit
- Premium Stainless 316 for the best corrosion resistance.
- Compact design for tight spaces

SEALTITE®
FITTINGS

STRAIGHT:



Trade Size	Item ID	Min. Int. Bore	Dimensions mm				KO Size NPT	Weight kg(lb)/100	Std. Pkg.
			A	B	C	E			
3/8"	714.112.92	11.0	35	14	26	24	1/2"	4.9 (10.8)	10
1/2"	714.116.92	14.5	36	14	29	27	1/2"	5.5 (12.1)	10
3/4"	714.120.92	19.4	37	14	35	33	3/4"	7.8 (17.2)	5
1"	714.126.92	24.7	40	16	45	42	1"	13.9 (30.6)	5
1-1/4"	714.135.92	33.3	43	16	53	52	1-1/4"	18.6 (41.0)	2
1-1/2"	714.140.92	38.0	50	18	62	60	1-1/2"	28.0 (61.7)	2
2"	714.150.92	49.0	56	20	76	72	2"	44.0 (97.0)	2

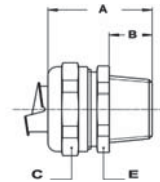

90 DEGREE:



Trade Size	Item ID	Min. Int. Bore	Dimensions mm					KO Size NPT	Weight kg(lb)/100	Std. Pkg.
			A	B	C	D	E			
3/8"	714.512.92	11.0	30	14	26	32	24	1/2"	8.7 (19.2)	10
1/2"	714.516.92	14.5	32	14	29	34	27	1/2"	10.1 (22.3)	10
3/4"	714.520.92	19.4	36	14	35	40	33	3/4"	16.7 (36.8)	5
1"	714.526.92	24.7	44	16	45	49	42	1"	29.6 (65.3)	5
1-1/4"	714.535.92	33.3	49	16	53	53	52	1-1/4"	43.2 (95.2)	2
1-1/2"	714.540.92	38.0	56	18	62	57	60	1-1/2"	59.5 (131.2)	2
2"	714.550.92	49.0	66	20	76	68	72	2"	93.6 (206.4)	2

