

METALLIC FITTINGS

SEALTITE® COMPACT FITTINGS NICKEL PLATED BRASS PREMIUM METRIC FITTINGS



SPECIFICATIONS

- Nickel Plated Brass w/ PA6 clamping ring
- O-ring included
- Colour: silver
- Temp. range: -45° C to + 105° C (-49° F to +221° F)
- cULus Approved # E234207

APPLICATIONS

- Metallic and Type B non-metallic flexible conduit
- Compact design ideal for tight spaces
- High-end appearance for good presentation

DESCRIPTION

- New compact design: 20% smaller and 35% lighter than standard SEALTITE® fittings. Ideal for tight spaces
- Excellent corrosion resistance, strength and durability
- IP 66/67 rated when installed with approved conduit and tightened to UL-514B/CSA C22.2 18.3 torque specifications
- Approved for both exposed and concealed locations

SEALTITE®
FITTINGS

STRAIGHT:



Trade Size	Thread ISO	Item ID	Min. Int. Bore	Dimensions mm				Weight kg(lb)/100	Std. Pkg.
				A	B	C	E		
3/8"	M16 x 1.5	712.016.1	11.0	31	10	26	24	3.9 (10.8)	10
3/8"	M20 x 1.5	712.017.1	11.0	31	10	26	24	4.0 (10.8)	10
1/2"	M20 x 1.5	712.020.1	14.5	32	10	29	27	4.4 (12.1)	10
3/4"	M25 x 1.5	712.025.1	19.4	33	10	35	33	6.6 (17.2)	5
1"	M32 x 1.5	712.032.1	24.7	36	12	45	42	11.7 (30.6)	5
1-1/4"	M40 x 1.5	712.040.1	33.3	40	13	53	52	16.0 (41.0)	2
1-1/2"	M50 x 1.5	712.050.1	38.0	46	14	62	60	25.3 (61.7)	2
2"	M63 x 1.5	712.063.1	49.0	52	16	76	72	38.6 (97.0)	2

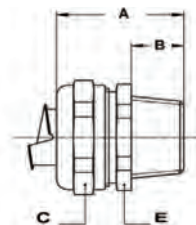

90 DEGREE:



Trade Size	Thread ISO	Item ID	Min. Int. Bore	Dimensions mm					Weight kg(lb)/100	Std. Pkg.
				A	B	C	D	E		
3/8"	M16 x 1.5	712.916.1	11.0	26	10	26	31	24	8.7 (19.2)	10
3/8"	M20 x 1.5	712.917.1	11.0	26	10	26	32	24	8.7 (19.2)	10
1/2"	M20 x 1.5	712.920.1	14.5	28	10	29	34	27	10.1 (22.3)	10
3/4"	M25 x 1.5	712.925.1	19.4	32	10	35	40	33	16.7 (36.8)	5
1"	M32 x 1.5	712.932.1	24.7	40	12	45	49	42	29.6 (65.3)	5
1-1/4"	M40 x 1.5	712.940.1	33.3	46	13	53	53	52	43.2 (95.2)	2
1-1/2"	M50 x 1.5	712.950.1	38.0	52	14	62	57	60	59.5 (131.2)	2
2"	M63 x 1.5	714.963.1	49.0	62	16	76	68	72	93.6 (206.4)	2

