

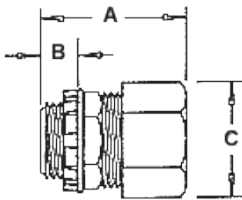

LT Connectors: Standard LT Series

Straight:



Trade	Item	Dimensions			KO Size	Weight	Standard
Size	ID	A	B	C		Kg/Pkg	Package
3/8"	LT38	36.57 (1.440)	12.95 (0.510)	32.00 (1.260)	1/2"	1.6	25
1/2"	LT50	36.57 (1.440)	13.08 (0.520)	35.18 (1.385)	1/2"	2.0	25
3/4"	LT75	39.75 (1.562)	12.70 (0.500)	43.69 (1.720)	3/4"	1.1	10
1"	LT100	46.35 (1.825)	15.06 (0.593)	48.26 (1.900)	1"	0.7	5
1-1/4"	LT125	52.53 (2.068)	15.87 (0.625)	55.27 (2.176)	1-1/4"	1.1	5
1-1/2"	LT150	51.00 (2.008)	15.87 (0.625)	63.68 (2.507)	1-1/2"	0.6	2
2"	LT200	53.42 (2.103)	15.06 (0.593)	80.72 (3.178)	2"	0.8	2

All dimensions in mm (inches)

90 Degree:

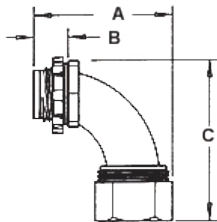

Trade	Item	Dimensions			KO Size	Weight	Standard
Size	ID	A	B	C		Kg/Pkg	Package
3/8"	LT9038	52.37 (2.062)	13.20 (0.520)	59.44 (2.340)	1/2"	1.0	10
1/2"	LT9050	54.05 (2.128)	13.34 (0.525)	58.72 (2.312)	1/2"	1.3	10
3/4"	LT9075	63.88 (2.515)	12.95 (0.510)	67.67 (2.664)	3/4"	1.6	10
1"	LT90100	70.05 (2.758)	17.15 (0.675)	92.46 (3.640)	1"	1.2	5
1-1/4"	LT90125	85.39 (3.362)	17.78 (0.700)	99.36 (3.912)	1-1/4"	0.8	2
1-1/2"	LT90150	88.90 (3.500)	15.34 (0.604)	110.95 (4.368)	1-1/2"	1.1	2
2"	LT90200	104.29 (4.106)	17.27 (0.680)	123.57 (4.865)	2"	1.5	2

All dimensions in mm (inches)
All dimensions in mm (inches)

LT Series Liquid-tight Connectors:



- Approved for any metallic flexible conduit as well as NMUA and NMEF Non-metallic conduits
- Disassembly not required for connection to liquid-tight conduit

SPECIFICATIONS:

- Zinc Die-Cast
- Colour: Silver
- Temperature range: -18°C to +90°C
- CSA Approved: # LR49636
- UL Approved: # E60812

SSLT Connectors: Stainless Steel Premium Connectors



Straight:



Trade	Item	Dimensions			KO Size	Weight	Standard
Size	ID	A	B	C		Kg/Pkg	Package
3/8"	SSLT38	37.00 (1.457)	13.00 (0.512)	26.00 (1.024)	1/2"	1.6	25
1/2"	SSLT50	37.00 (1.457)	13.00 (0.512)	29.00 (1.142)	1/2"	2.0	25
3/4"	SSLT75	40.00 (1.575)	15.00 (0.591)	35.00 (1.379)	3/4"	1.1	10
1"	SSLT100	46.00 (1.811)	15.00 (0.591)	45.00 (1.772)	1"	0.7	5

All dimensions in mm (inches)

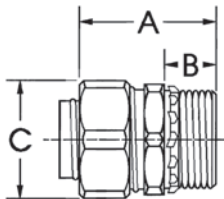

90 Degree:



Trade	Item	Dimensions				KO Size	Weight	Standard
Size	ID	A	B	C	D		Kg/Pkg	Package
3/8"	SSLT9038	36.00 (1.417)	13.00 (0.512)	26.00 (1.024)	43.00 (1.693)	1/2"	1.0	10
1/2"	SSLT9050	36.00 (1.417)	13.00 (0.512)	29.00 (1.142)	43.00 (1.693)	1/2"	1.3	10
3/4"	SSLT9075	43.00 (1.693)	15.00 (0.591)	35.00 (1.379)	48.00 (1.890)	3/4"	1.6	10
1"	SSLT90100	48.00 (1.890)	15.00 (0.591)	45.00 (1.772)	59.00 (2.323)	1"	1.2	5

All dimensions in mm (inches)

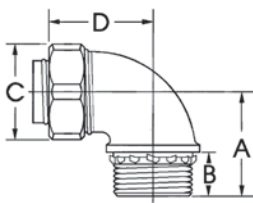

SSLT Series Liquid-tight Connectors:



- Approved for any metallic flexible conduit as well as NMUA and NMEF Non-metallic conduits

SPECIFICATIONS:

- 303 Stainless Steel
- Colour: Silver
- Temperature range: -45°C to +105°C
- cUL Approved: # E234207
- UL Approved: # E234207