

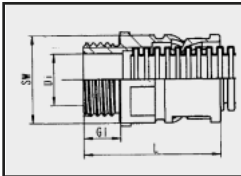

Type AFN - __ N __ B: Fittings with NPT Threads

NPT Thread Straight Fittings



| Size | Item | Thread | Dimensions mm (inches) | | | Std. Pkg. |
|-------|---------------|-------------|------------------------|------------|------------|-----------|
| | | | GL | SW | L | |
| NW 12 | AFN0-12N 050B | 1/2" (16) | 8 (.315) | 21 (.827) | 31 (1.220) | 25 |
| NW 17 | AFN0-17N 050B | 1/2" (16) | 10 (.394) | 27 (1.063) | 36 (1.417) | 25 |
| NW 23 | AFN0-23N 075B | 3/4" (21) | 12 (.472) | 36 (1.417) | 41 (1.614) | 10 |
| NW 29 | AFN0-29N 100B | 1" (27) | 12 (.472) | 40 (1.575) | 43 (1.693) | 10 |
| NW 36 | AFN0-36N 125B | 1-1/4" (35) | 15 (.591) | 50 (1.969) | 54 (2.126) | 10 |
| NW 48 | AFN0-48N 150B | 1-1/2" (41) | 15 (.591) | 65 (2.559) | 58 (2.283) | 10 |
| NW 48 | AFN0-48N 200B | 2" (53) | 15 (.591) | 65 (2.559) | 58 (2.283) | 10 |

NPT Thread 45° Fittings

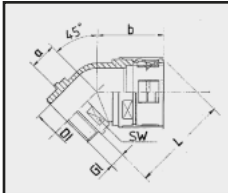

| Size | Item | Thread | Dimensions mm (inches) | | | Std. Pkg. |
|-------|---------------|-----------|------------------------|------------|------------|-----------|
| | | | GL | SW | L | |
| NW 23 | AFN4-23N 075B | 3/4" (21) | 12 (.427) | 36 (1.417) | 64 (2.520) | 10 |
| NW 29 | AFN4-29N 100B | 1" (27) | 12 (.427) | 40 (1.575) | 75 (2.953) | 10 |

NPT Thread 90° Fittings

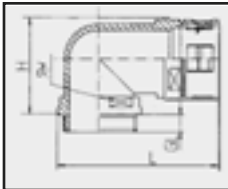

| Size | Item | Thread | Dimensions mm (inches) | | | | Std. Pkg. |
|-------|---------------|-------------|------------------------|------------|-------------|------------|-----------|
| | | | GL | SW | L | H | |
| NW 12 | AFN9-12N 050B | 1/2" (16) | 8 (.315) | 21 (.827) | 50 (1.969) | 30 (1.181) | 25 |
| NW 17 | AFN9-17N 050B | 1/2" (16) | 10 (.394) | 27 (1.063) | 59 (2.323) | 35 (1.378) | 25 |
| NW 23 | AFN9-23N 075B | 3/4" (21) | 12 (.472) | 36 (1.417) | 78 (3.071) | 44 (1.732) | 10 |
| NW 29 | AFN9-29N 100B | 1" (27) | 12 (.472) | 40 (1.575) | 88 (3.465) | 52 (2.047) | 10 |
| NW 36 | AFN9-36N 125B | 1-1/4" (35) | 16 (.630) | 50 (1.969) | 103 (4.055) | 67 (2.638) | 10 |
| NW 48 | AFN9-48N 150B | 1-1/2" (41) | 16 (.630) | 65 (2.559) | 126 (4.961) | 82 (3.228) | 10 |
| NW 48 | AFN9-48N 200B | 2" (53) | 16 (.430) | 65 (2.559) | 126 (4.961) | 82 (3.228) | 10 |

Lock nuts are NOT included with fittings.
Fitting Specifications on Page 5.

ANA-QUICK Fittings



Type AFN_ - __P__B: Fittings with PG Threads and Flange Fittings

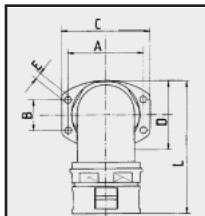
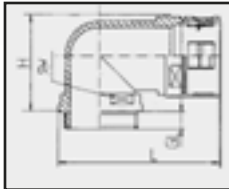
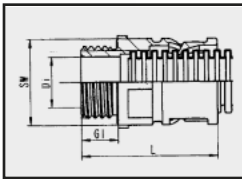

PG Thread Straight Fittings



| Size | Item | Thread | Dimensions mm (inches) | | | Std. Pkg. |
|------|-------------|---------|------------------------|------------|------------|-----------|
| | | | GL | SW | L | |
| NW | ID | Size | | | | |
| 7.5 | AFN0-07P07B | PG 7 | 7 (.276) | 14 (.551) | 24 (.945) | 25 |
| 10 | AFN0-10P09B | PG 9 | 8 (.315) | 19 (.748) | 28 (1.102) | 25 |
| 12 | AFN0-12P11B | PG 11 | 8 (.315) | 21 (.827) | 31 (1.220) | 25 |
| 17 | AFN0-17P13B | PG 13.5 | 10 (.394) | 27 (1.063) | 36 (1.417) | 25 |
| 23 | AFN0-23P21B | PG 21 | 12 (.472) | 36 (1.417) | 41 (1.614) | 10 |
| 29 | AFN0-29P29B | PG 29 | 12 (.472) | 40 (1.575) | 43 (1.693) | 10 |
| 36 | AFN0-36P36B | PG 36 | 15 (.591) | 50 (1.969) | 54 (2.126) | 10 |
| 48 | AFN0-48P48B | PG 48 | 15 (.591) | 65 (2.559) | 58 (2.283) | 10 |

PG Thread 90° Fittings



| Size | Item | Thread | Dimensions mm (inches) | | | | Std. Pkg. |
|------|-------------|---------|------------------------|------------|------------|------------|-----------|
| | | | GL | SW | L | H | |
| NW | ID | Size | | | | | |
| 12 | AFN9-12P11B | PG 11 | 8 (.315) | 21 (.827) | 50 (1.969) | 30 (1.181) | 25 |
| 17 | AFN9-17P13B | PG 13.5 | 10 (.394) | 27 (1.063) | 59 (2.323) | 35 (1.378) | 25 |
| 23 | AFN9-23P21B | PG 21 | 12 (.472) | 36 (1.417) | 78 (3.071) | 44 (1.732) | 10 |

90° Flange Fittings



| Size | Item | Bore Size | Dimensions mm (inches) | | | Std. Pkg. |
|------|----------|-----------|-------------------------|------------|------------|-----------|
| | | | A / B | C | E | |
| NW | ID | Size | | | | |
| 17 | AFNF-17B | 16.4 | 36 (1.417) | 46 (1.811) | 5.5 (.217) | 10 |
| 23 | AFNF-23B | 22.8 | 53 (2.087) | 63 (2.480) | 6.5 (.256) | 10 |
| 29 | AFNF-29B | 27.0 | 54 (2.216) / 36 (1.417) | 67 (2.638) | 6.5 (.256) | 10 |
| 36 | AFNF-36B | 38.3 | 73 (2.874) / 30 (1.181) | 86 (3.387) | 6.5 (.256) | 10 |
| 48 | AFNF-48B | 47.7 | 73 (2.874) / 30 (1.181) | 86 (3.386) | 6.5 (.256) | 5 |

Lock nuts are NOT included with fittings.
PG lock nuts are available (see Page 15).

ANA-QUICK Fittings (page 10-11) Specifications:

Standard **ANA-QUICK Fittings** are made from PA6 Nylon and are rated IP65. These fittings are designed to fit all ANA-QUICK conduit types and can be disassembled from the conduit after they have been assembled by using the Quick-Key safety opener.



SPECIFICATIONS:

Construction:

Modified Polyamide (PA6V0),
Halogen Free.

Flame Properties:

Self Extinguishing

Resistant:

Alcohol, greases, fuels, mineral
spirits, weak bases and weak
acids.

IP Rating:

IP 65 (IP67 & IP68 options)

Temperature Range:

-40°C to +110°C

Colour: Black

Approval:

UL Recognized E148858

APPLICATIONS:

- All ANA-QUICK conduit types.
- Vibration areas
- Wash down areas (when assembled with OD seal.)

ANA-QUICK Fitting Assembly / Disassembly Guide:

ANA-QUICK fittings are easily assembled by just pushing the conduit into the fitting. The unique locking mechanism firmly holds the conduit in place, without the possibility of inadvertent removal.

In order to disassemble the conduit, a Quick-Key is required. This allows control of the possible tampering of the conduit by controlling access to the Quick-Keys.





**Type AF_S:
Seals for IP68 Rating**

Seals for ANA-QUICK Fittings

For applications that require a water-tight seal, you can upgrade the connector from IP65 to IP67. IP68 is available by special order. To get an IP67 rating, just add OD Seal. To further protect the connector from collecting debris, the OD seal can be added to the IP68 connector.



| | |
|---------------------------------|---|
| IP 65: |  |
| IP 67: |  |
| IP 68 connector (spec. order): |  |
| IP 68 connector with AFOS seal: |  |

OD Seal



| Size | Item | Std. |
|------|----------|------|
| NW | ID | Pkg. |
| 12 | AFOS-12G | 25 |
| 17 | AFOS-17G | 25 |
| 23 | AFOS-23G | 10 |
| 29 | AFOS-29G | 10 |
| 36 | AFOS-36G | 10 |
| 48 | AFOS-48G | 10 |